

OKLAHOMA DEPARTMENT OF TRANSPORTATION				
FED. ROAD DIST. NO.	STATE	STATE JOB NO.	FISCAL YEAR	SHEET NO. / TOTAL SHEETS
	OKLA	29289(04)		27
DESCRIPTION		REVISIONS	DATE	

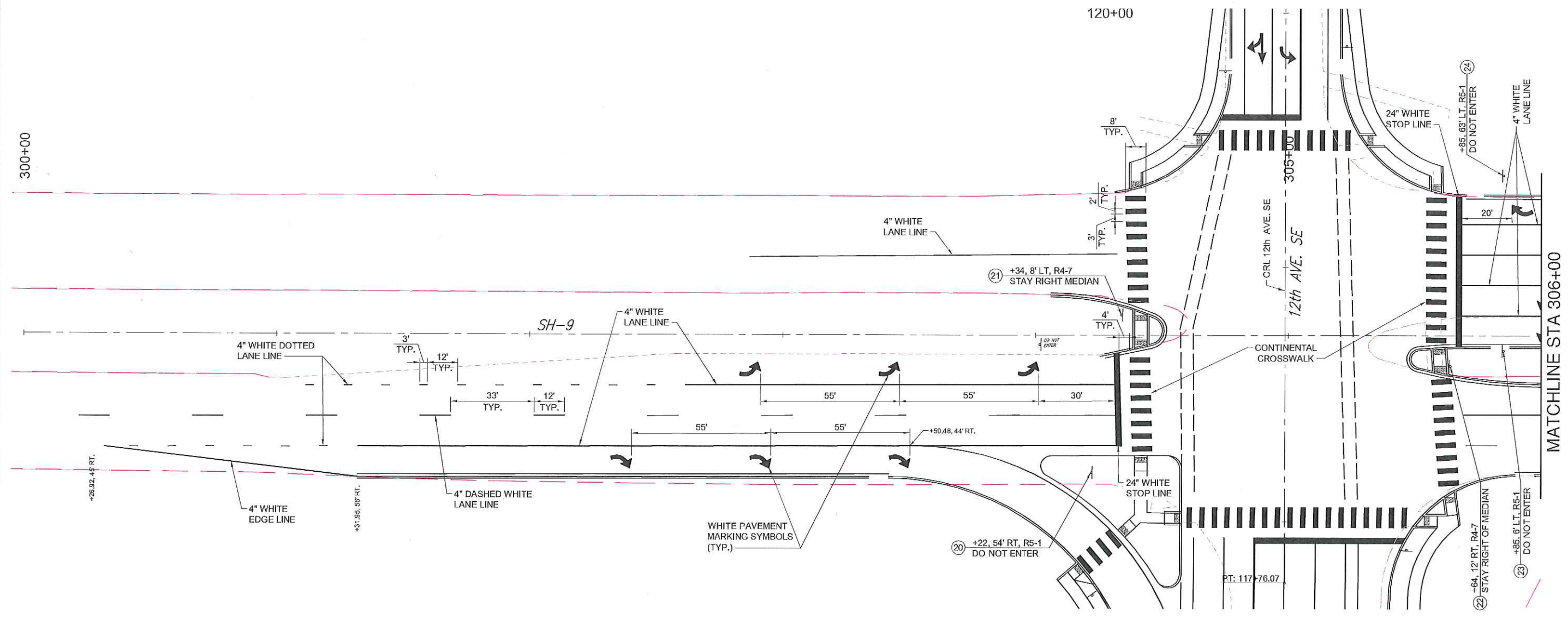
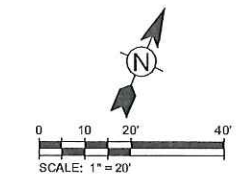

- NOTES:**
- ALL PAVEMENT MARKINGS OVER CONCRETE SHALL BE MULTI-POLYMER AND MARKINGS OVER ASPHALT SHALL CONSIST OF HOT APPLIED THERMOPLASTIC COMPOUND IN ACCORDANCE WITH SEC. 855A OF THE ODOT SPECIFICATIONS.

DESIGN	SKC	OKLAHOMA DEPARTMENT OF TRANSPORTATION SIGNAGE & STRIPING PLAN STATE JOB NO. <u>29289(04)</u>
DRAWN	T1	
CHECKED	SKC	
APPROVED	MNR	
SQUAD	T1	
		SHEET NO. <u>27</u> CLEVELAND COUNTY

2/16/2017 4:46:04 PM - P:\088512\131-08512-1300\1\CAD\SH-9\FILES\SIGNAGE & STRIPING PLAN.DWG - RODRIGUEZ, AMY